

Bus enclosures BG



Bus enclosures

Material:

Sheet steel
 Enclosure: 1.38 mm
 Door: 1.5 mm
 Viewing window made from polycarbonate, 4 mm

Surface finish:

Enclosure and door:
 Powder-coated in textured RAL 7035

Protection category:

IP 65 to EN 60 529/09.2000,
 complies with NEMA 12.

Supply includes:

Door with l/h hinge,
 1 cam lock with double-bit insert,
 2 (1) support rail(s) TS 35/7.5 (for BG 1586.510).
 Drilled holes for cable glands in the base.

Approvals,

see page 26.

Dimensions mm			PG version					Metric version			Model No. BG	Model No. BG
			Number of PG holes					Number of metric holes				
W (B)	H	D (T)	9	11	13.5	16	21	M12	M20	M25		
200	300	80	1	8	-	1	1	2	5	2	1583.510	
300	300	80	1	14	-	1	1	2	9	2	1584.510	
400	300	80	1	18	-	1	2	2	13	3	1585.510	
500	300	80	3	-	24	-	-	3	24	-	1586.510	

Lock systems

Standard double-bit lock insert may be exchanged for lock inserts, type A, see page 956 and plastic handles, type B, see page 954.

To order enclosures in RAL 7032, please add the extension .210 or .220 to the Model No. Delivery times available on request.

PG

BG 1583.510

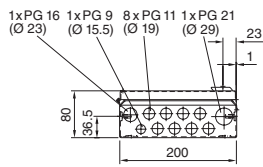

Metric

BG 1583.520

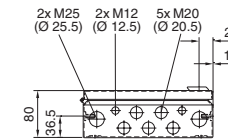

BG 1584.510

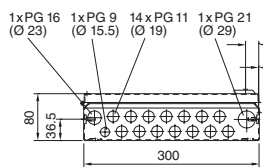

BG 1584.520

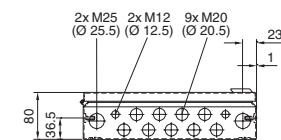

BG 1585.510

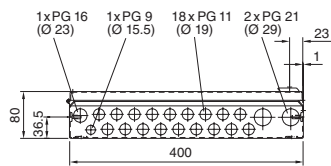

BG 1585.520

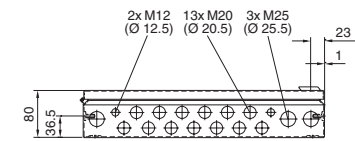

BG 1586.510

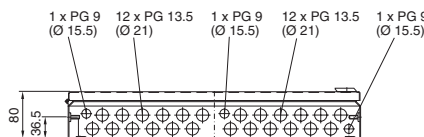

BG 1586.520

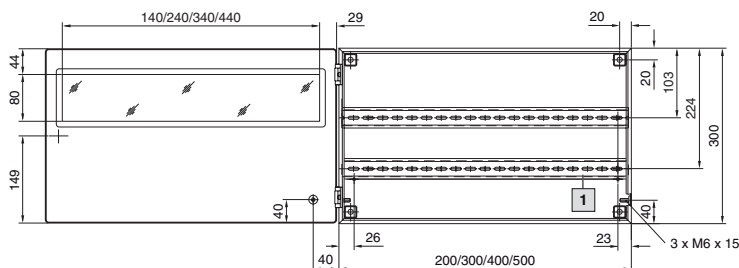
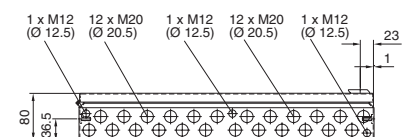

1 Not applicable to BG 1586.510



Bus enclosure

Material:

Sheet steel
Enclosure: 1.38 mm
Door: 1.5 mm
Viewing window made from polycarbonate, 4 mm

Surface finish:

Enclosure and door:
Powder-coated in textured RAL 7035

Protection category:

IP 65 to EN 60 529/09.2000,
complies with NEMA 12.

Supply includes:

Door with r/h hinge,
1 cam lock with double-bit insert,
1 support rail TS 35/7.5.
Holes for screwed cable glands in the base.



Accessories:

Cable glands made from polyamide or brass,
see page 1054.

Approvals,

see page 26.

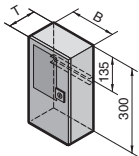
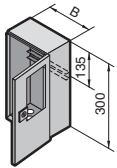

Dimensions in mm			Number of metric holes				Model No. BG
W (B)	H	D (T)	M12	M20	M32	M50	
200	300	120	2	–	5	–	1605.520
400	300	120	–	2	9	1	1606.520

Lock systems

Standard double-bit lock insert may be exchanged for lock inserts, type A, see page 956
and plastic handles, type B, see page 954.

To order enclosures in RAL 7032, please add the extension .220 to the Model No.

Delivery times available on request.

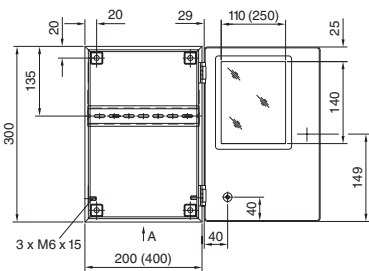

BG 1605.520

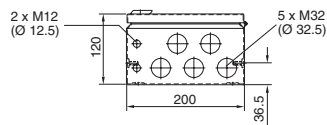

BG 1606.520

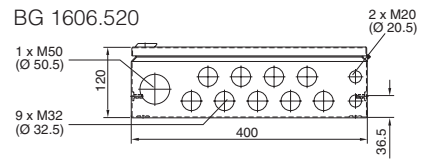

Bus enclosure

Material:

Sheet steel
Enclosure: 1.38 mm
Door: 1.5 mm
Viewing window made from polycarbonate, 4 mm

Surface finish:

Enclosure and door:
Dipcoat-primed, powder-coated in
textured RAL 7035

Protection category:

IP 65 to EN 60 529/09.2000,
complies with NEMA 12.

Dimensions in mm			Model No. BG
W (B)	H	D (T)	
400	200	125	1558.510
600	200	125	1559.510

To order enclosures in RAL 7032, please add the extension .210 to the Model No.
Delivery times available on request.

Supply includes:

Door hinged at the bottom,
2 (3) quick-release fasteners for screwdriver
(with BG 1559.510),
1 support rail TS 35/7.5,
1 gland plate at the bottom.



Accessories:

for BG 1559.150
gland plates, size 6,
see page 1050.

Approvals,

see page 26.

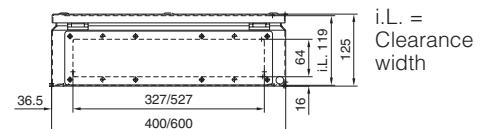
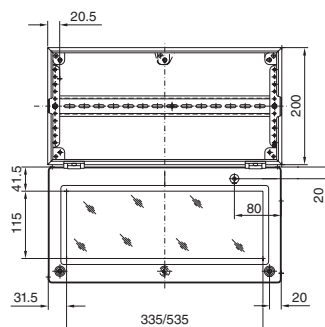
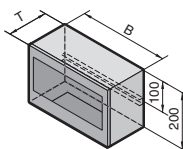
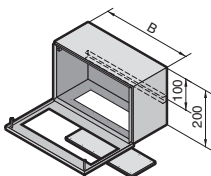

Bus enclosures BG



Bus enclosure

Material:
 Sheet steel
 Enclosure: 1.38 mm
 Door: 1.5 mm
 Polycarbonate viewing window (not all versions)
 Zinc-coated mounting plate

Surface finish:
 Enclosure and door:
 Powder-coated in textured RAL 7035

Protection category:
 IP 65 to EN 60 529/09.2000,
 complies with NEMA 12.

Supply includes:
 Door hinged at the bottom,
 cam locks with double-bit insert,
 may be exchanged for type A lock inserts,
 page 956 and type B plastic handles, page 954.

Modification:
 Viewing window and gland plate as per selection

Approvals,
 see page 26.

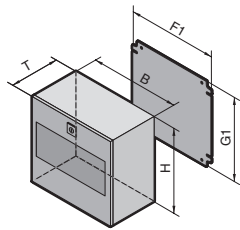
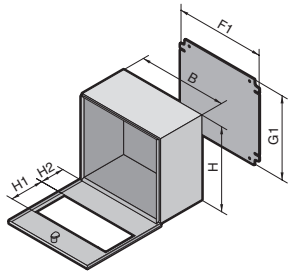

Selection	W (B)	H	D (T)	F1	G1	Cam lock	Heights of viewing windows mm		Gland plate opening clearance width x clearance width 97 ²⁾	Model No. EB/BG		
							H1	H2		Basic	Extension	
Step 1: Enclosure dimensions	400	300	155	385	275	1			327 x 97	1577.		
	600	300	155	585	275	2			527 x 97	1578.		
	800	300	155	785	275	2			327 x 97 (2 x)	1579.		
									without viewing window		.500	
									115	92	without	.520¹⁾
									190	42	without	.530¹⁾
									115	92	with, depending on the selected base	.550¹⁾
									190	42	with, depending on the selected base	.560¹⁾
									155	92	without	.450¹⁾

To order enclosures in RAL 7032, please add the extension .6X0 to the Model No. Delivery times available on request.

¹⁾ Extended delivery times. ²⁾ Gland plates 14 mm larger all round.

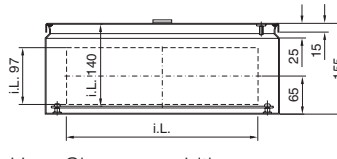
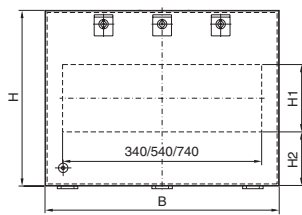

i.L. = Clearance width

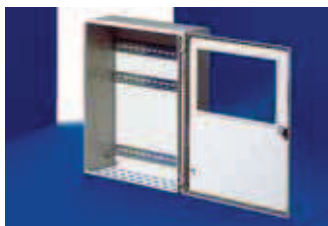
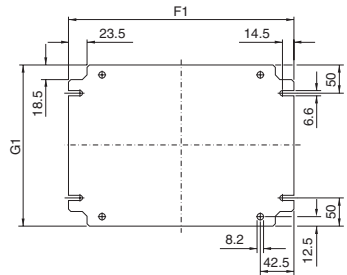

Bus enclosure

Material:
 Sheet steel
 Enclosure: 1.38 mm
 Door: 1.5 mm
 Viewing window made from polycarbonate, 4 mm

Surface finish:
 Enclosure and door:
 Powder-coated in textured RAL 7035

Protection category:
 IP 65 to EN 60 529/09.2000,
 complies with NEMA 12.

Approvals,
 see page 27.

Dimensions in mm			Number of drilled holes for PG 13.5 or M20	Model No. BG
W (B)	H	D (T)		
400	500	160	33	1611.510

To order enclosures in RAL 7032, please add the extension .210 to the Model No. Delivery times available on request.

Supply includes:
 Door with r/h hinge,
 1 cam lock with 3 mm double-bit insert,
 may be exchanged for type A lock inserts,
 page 956 and type B plastic handles, page 954.
 3 support rails TS 35/7.5.
 Holes for screwed cable glands in the base.

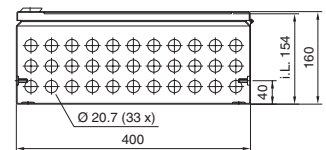
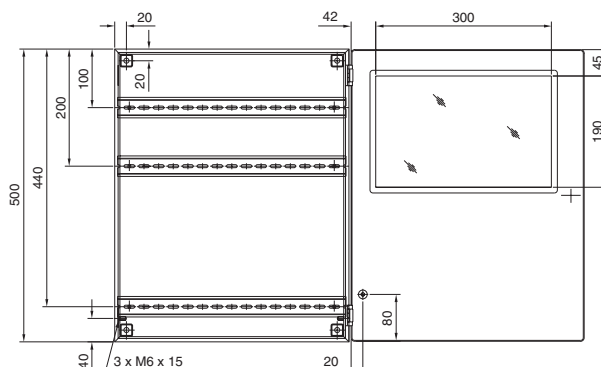
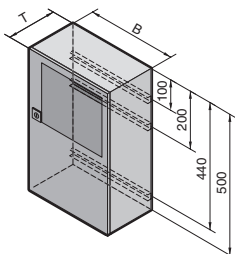
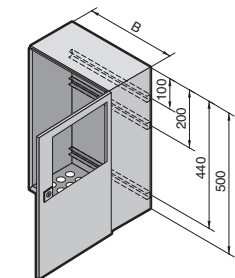

i.L. = Clearance width

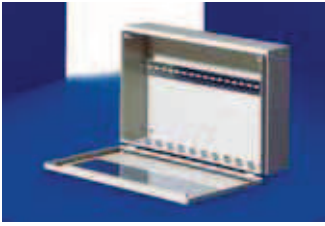

Bus enclosure

Material:

Sheet steel
Enclosure: 1.38 mm
Door: 1.5 mm
Viewing window made from polycarbonate, 4 mm

Surface finish:

Enclosure and door:
Powder-coated in textured RAL 7035

Protection category:

IP 65 to EN 60 529/09.2000,
complies with NEMA 12.

Dimensions in mm			Number of drilled holes for PG 13.5 or M20	Model No. BG
W (B)	H	D (T)		
500	300	120	48	1609.510

To order enclosures in RAL 7032, please add the extension .210 to the Model No. Delivery times available on request.

Supply includes:

Door hinged at the bottom,
2 quick-release fasteners for screwdrivers,
1 support rail TS 35/7.5.
Holes for screwed cable glands in the base.

Accessories:

Cable glands made from polyamide or brass, see page 1054.

Approvals, see page 27.

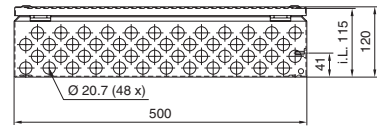

i.L. = Clearance width

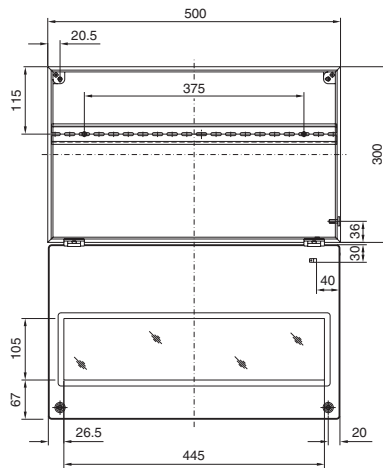
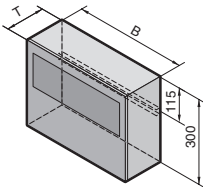
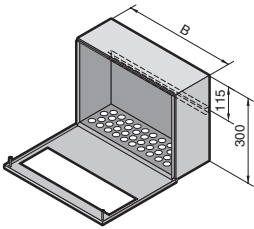

Bus enclosure for modular cable entry

Material:

Sheet steel
Enclosure: 1.38 mm
Door: 1.5 mm
Viewing window made from polycarbonate, 4 mm

Surface finish:

Enclosure and door:
Powder-coated in textured RAL 7035

Protection category:

IP 55 to EN 60 529/09.2000,
complies with NEMA 12
(in conjunction with module plates).

Width mm	Height mm	Depth (T) mm	Model No. BG
500	500	210	1050.900

Delivery times available on request.

Supply includes:

18 cut-outs in the base for module plates,
pre-configured top-hat rail for bus systems
(I/O modules, motor starters) and terminal blocks.
Door with viewing panel for visual monitoring of
the installed components.

Also required:

Module plates,
see page 1051.

Approvals,
see page 27.

